



RESIDENCE

111 Kylepark Drive, Uddingston, G71 7DE

www.residencestateagents.co.uk



Viewing by appointment with Residence Uddingston

T: 01698 444222 | E: uddingston@residencestateagents.co.uk | A: 61-63 Main Street, Uddingston, G71 7EP



RESIDENCE



3 Bedrooms | 4 Public Rooms | 2 Bathrooms



Rarely available, beautifully presented detached sandstone villa situated within one of Uddingston's most sought-after addresses on Kylepark Drive.

This impressive home perfectly blends the charm and character of traditional architecture with the comfort and convenience of modern family living.

Internally, the property offers bright, spacious, and versatile accommodation, with beautifully proportioned rooms and an abundance of original features, including detailed cornicing and feature fireplaces.

The heart of the home is the stunning open-plan modern fitted kitchen, seamlessly flowing into the family dining and sunroom area to the rear, creating an ideal space for both everyday family life and entertaining. From here, access is provided to a versatile vestibule and WC, while the kitchen also leads directly to the utility room.

The ground floor accommodation comprises a welcoming reception hallway, elegant front-facing bay-window lounge and bay-window dining room, a versatile rear sitting room/fourth bedroom, modern kitchen/family dining room, utility room, and WC.

The upper level offers three generously sized bedrooms, including a principal bedroom with its own shower room, alongside a beautifully appointed family bathroom.

Further benefits include gas central heating and double glazing throughout.

Externally, the rear garden provides a wonderful outdoor space with a patio area, well-maintained lawn, mature shrubs, and attractive bedding, while a detached garage to the rear of the property adds further practicality. To the front, the property enjoys an exceptionally large driveway and landscaped lawn.



1959.00 sq ft | EER = D



RESIDENCE





RESIDENCE





RESIDENCE





RESIDENCE



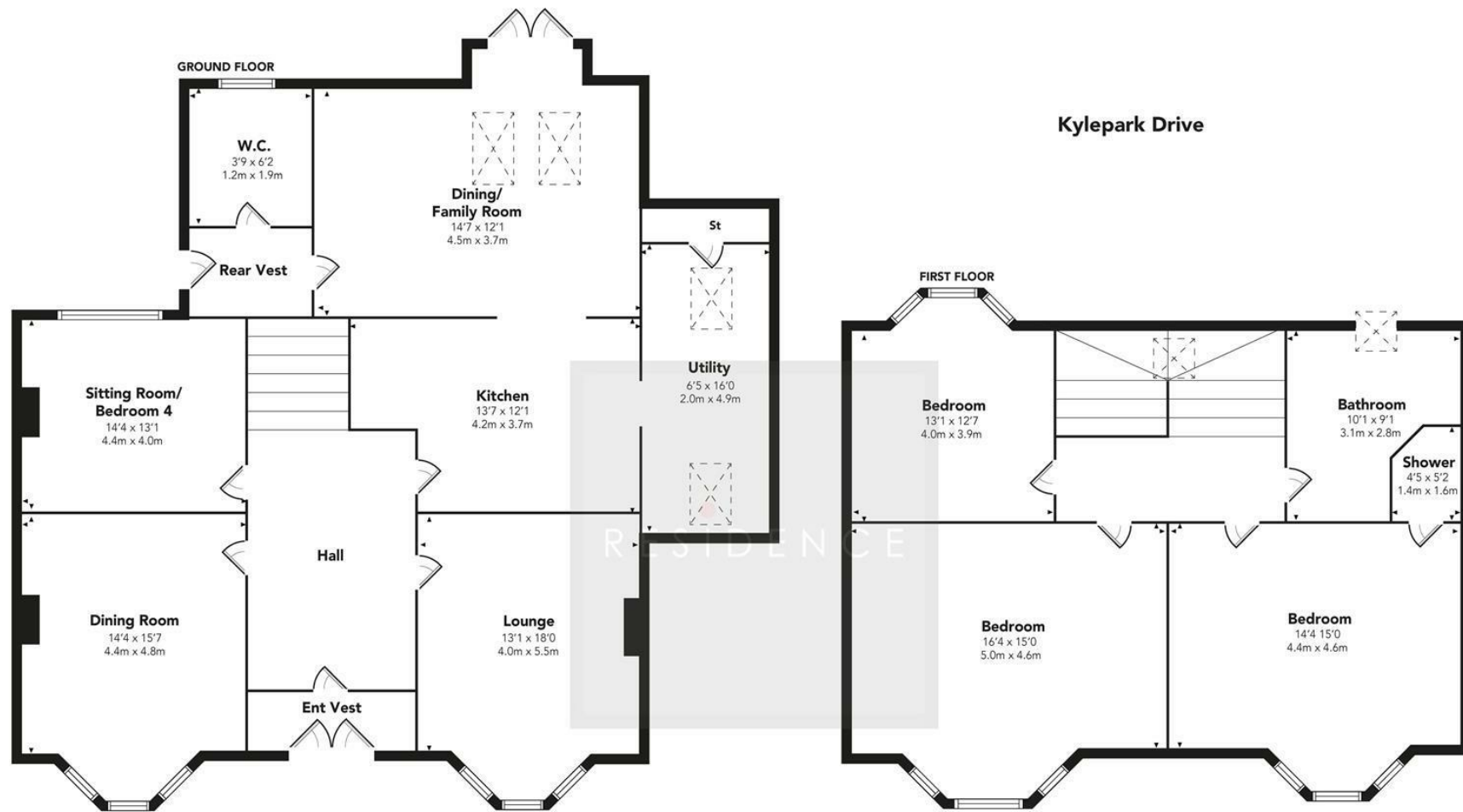

Floor Plan measurements are approximate and are for illustrative purposes only. While we do not doubt the floor plans accuracy, we make no guarantee, warranty or representation as to the accuracy and completeness of the floor plan. You or your advisors should conduct a careful, independent investigation of the property to determine to your satisfaction as to the suitability of the property for your space requirements.
Produced by Plush Plans Ltd

We believe these details to be accurate; however, they do not form any part of a contract. Fixtures and fittings are not included unless specified in the enclosed. Photographs are for general information and it must not be inferred that any item is included for sale with the property. All distances and measurements are approximate. Floorplans may not be to scale and are for illustration purposes only.